

# ETC-SV7

## Catalytic air treatment



### TECHNICAL SPECIFICATION

› Flow rate at 7 barg / 100 psig	7 Nm <sup>3</sup> /min	247 scfm
› Max. pressure	16 barg	232 psig
› Air quality for oil according to ISO 8573-1	class 0 (< 0.0025 mg/Nm <sup>3</sup> )	
› Weight approx.	410 kg	900 lbs
› Power supply	400 VAC, 3 ph, 50 Hz	
› Installed power	5 kW	
› power consumption	0.006 kWh/Nm <sup>3</sup>	

### ››› Dimensions

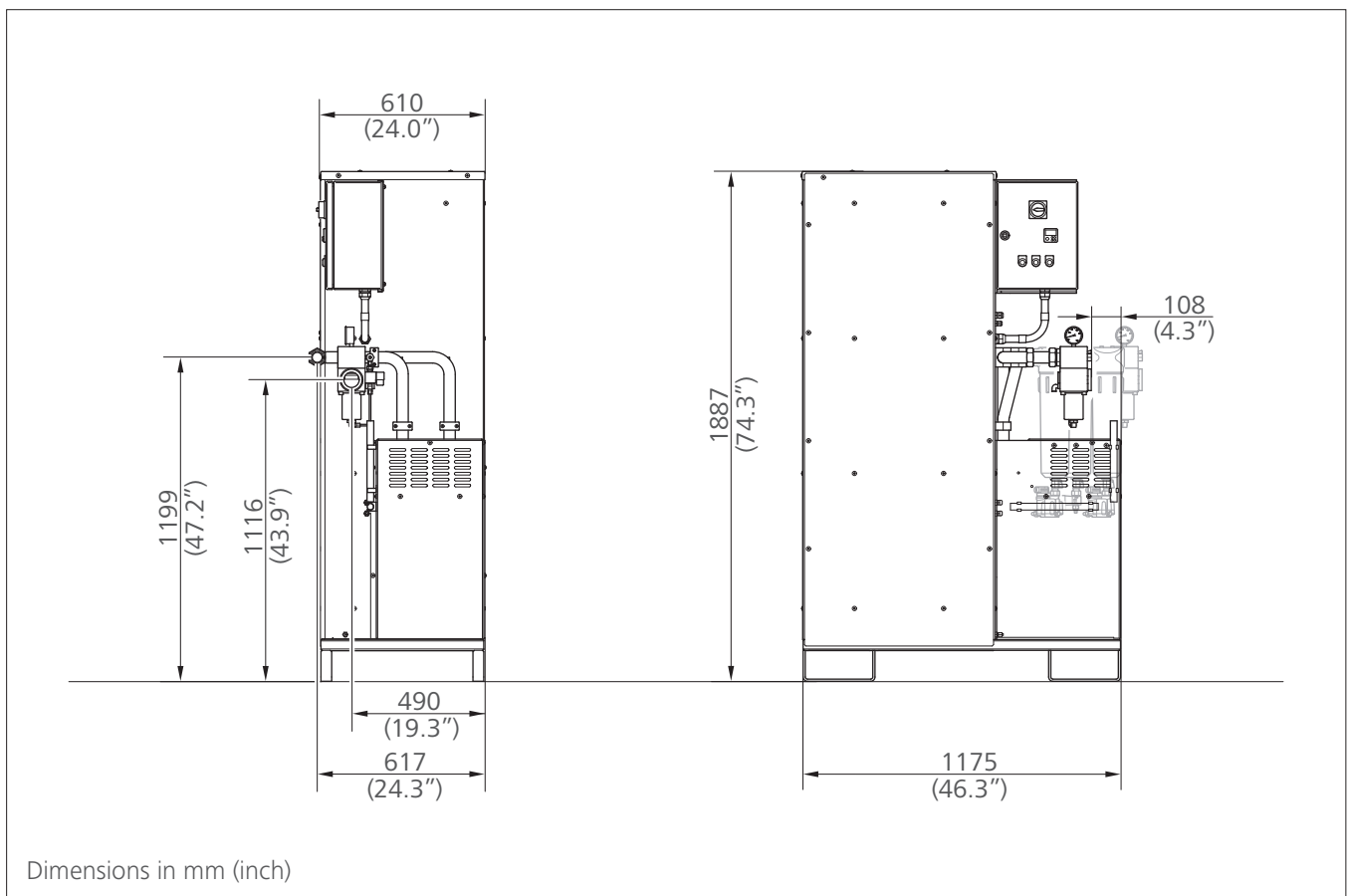

Without separator, VS-modul and particle filter.  
 For detailed layout, please ask for the installation drawing/3d model.



## »»» Design data

Permissible deviations from the design data for guaranteed oil-free air class 0 according to DIN ISO 8573-1

	Operating pressure		Nominal flow rate* 100%		Flow rate range <b>without</b> VS module* 70% – 110%		Flow rate range <b>with</b> VS module* 20% – 110%	
	[barg]	[psig]	[Nm <sup>3</sup> /min]	[scfm]	[Nm <sup>3</sup> /min]	[scfm]	[Nm <sup>3</sup> /min]	[scfm]
	5	72.5	5.3	185	3.7 - 5.8	130 - 204	1.1 - 5.8	37 - 204
	6	87.0	6.1	216	4.3 - 6.7	151 - 238	1.2 - 6.7	43 - 238
<b>Design point</b>	7	101.5	7.0	247	4.9 - 7.7	173 - 272	1.4 - 7.7	49 - 272
	8	116.0	7.9	278	5.5 - 8.7	195 - 306	1.6 - 8.7	56 - 306
	9	130.5	8.8	309	6.1 - 9.6	216 - 340	1.8 - 9.6	62 - 340
	10	145.0	9.6	340	6.7 - 10.6	238 - 374	1.9 - 10.6	68 - 374
	11	159.5	10.5	371	7.4 - 11.6	260 - 408	2.1 - 11.6	74 - 408
	12	174.0	11.4	402	8.0 - 12.5	281 - 442	2.3 - 12.5	80 - 442

\* Normal flow rate according to DIN ISO 13431

Pressures greater than 12 barg are available on request

## »»» Design chart

