

ETC-SV5

Catalytic air treatment



TECHNICAL SPECIFICATION

› Flow rate at 7 barg / 100 psig	5 Nm ³ /min	177 scfm
› Max. pressure	16 barg	232 psig
› Air quality for oil according to ISO 8573-1	class 0 (< 0.0025 mg/Nm ³)	
› Weight approx.	360 kg	790 lbs
› Power supply	400 VAC, 3 ph, 50 Hz	
› Installed power	5 kW	
› power consumption	0.007 kWh/Nm ³	

››› Dimensions

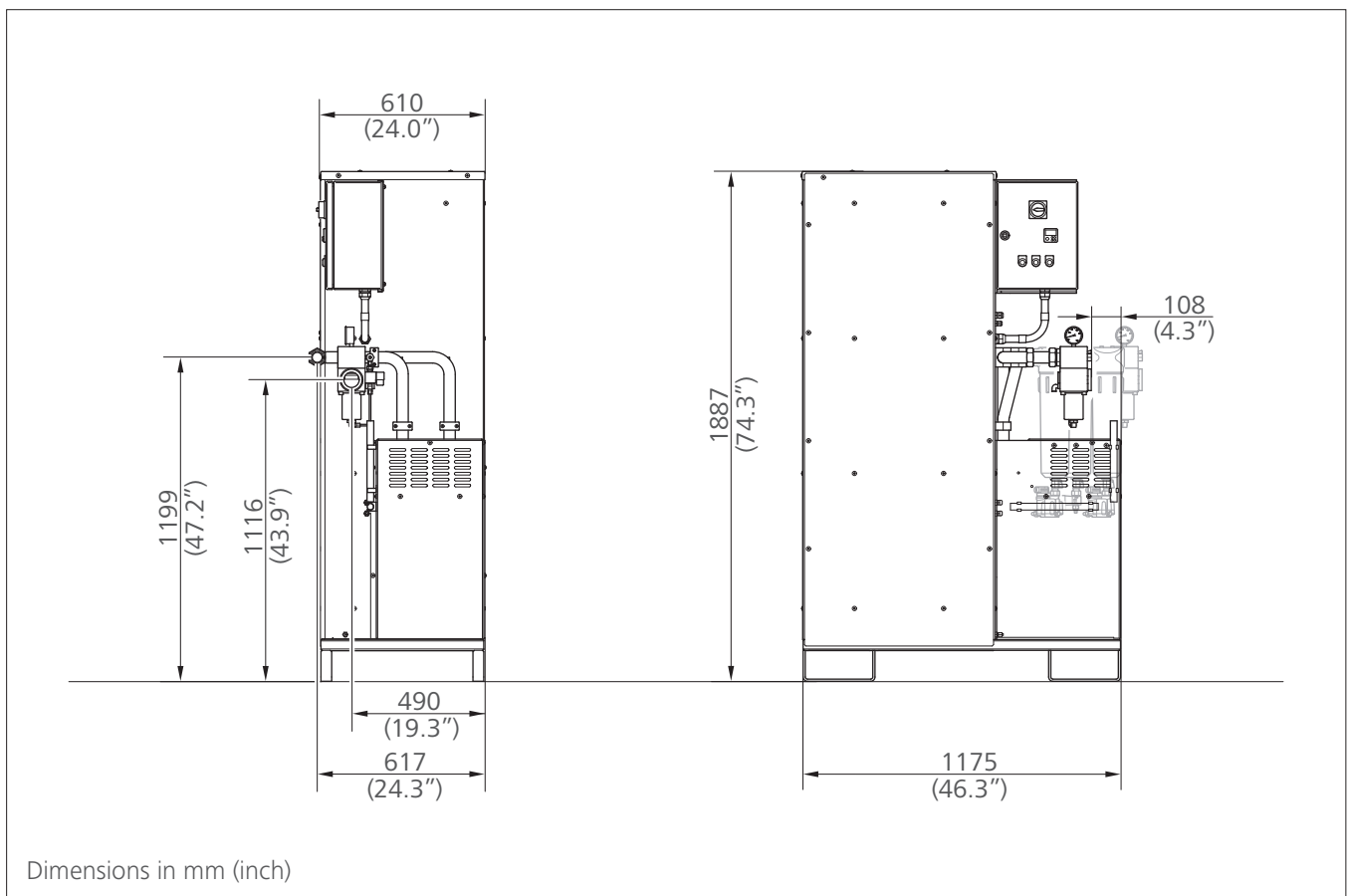

Without separator, VS-modul and particle filter.
For detailed layout, please ask for the installation drawing/3d model.



Design data

Permissible deviations from the design data for guaranteed oil-free air class 0 according to DIN ISO 8573-1

	Operating pressure		Nominal flow rate* 100%		Flow rate range without VS module* 70% – 110%		Flow rate range with VS module* 20% – 110%	
	[barg]	[psig]	[Nm ³ /min]	[scfm]	[Nm ³ /min]	[scfm]	[Nm ³ /min]	[scfm]
	5	72.5	3.8	132	2.6 - 4.1	93 - 146	0.8 - 4.1	26 - 146
	6	87.0	4.4	154	3.1 - 4.8	108 - 170	0.9 - 4.8	31 - 170
Design point	7	101.5	5.0	177	3.5 - 5.5	124 - 194	1.0 - 5.5	35 - 194
	8	116.0	5.6	199	3.9 - 6.2	139 - 218	1.1 - 6.2	40 - 218
	9	130.5	6.3	221	4.4 - 6.9	154 - 243	1.3 - 6.9	44 - 243
	10	145.0	6.9	243	4.8 - 7.6	170 - 267	1.4 - 7.6	49 - 267
	11	159.5	7.5	265	5.3 - 8.3	185 - 291	1.5 - 8.3	53 - 291
	12	174.0	8.1	287	5.7 - 8.9	201 - 316	1.6 - 8.9	57 - 316

* Normal flow rate according to DIN ISO 13431

Pressures greater than 12 barg are available on request

Design chart

